

LOCATION PLAN - NTS

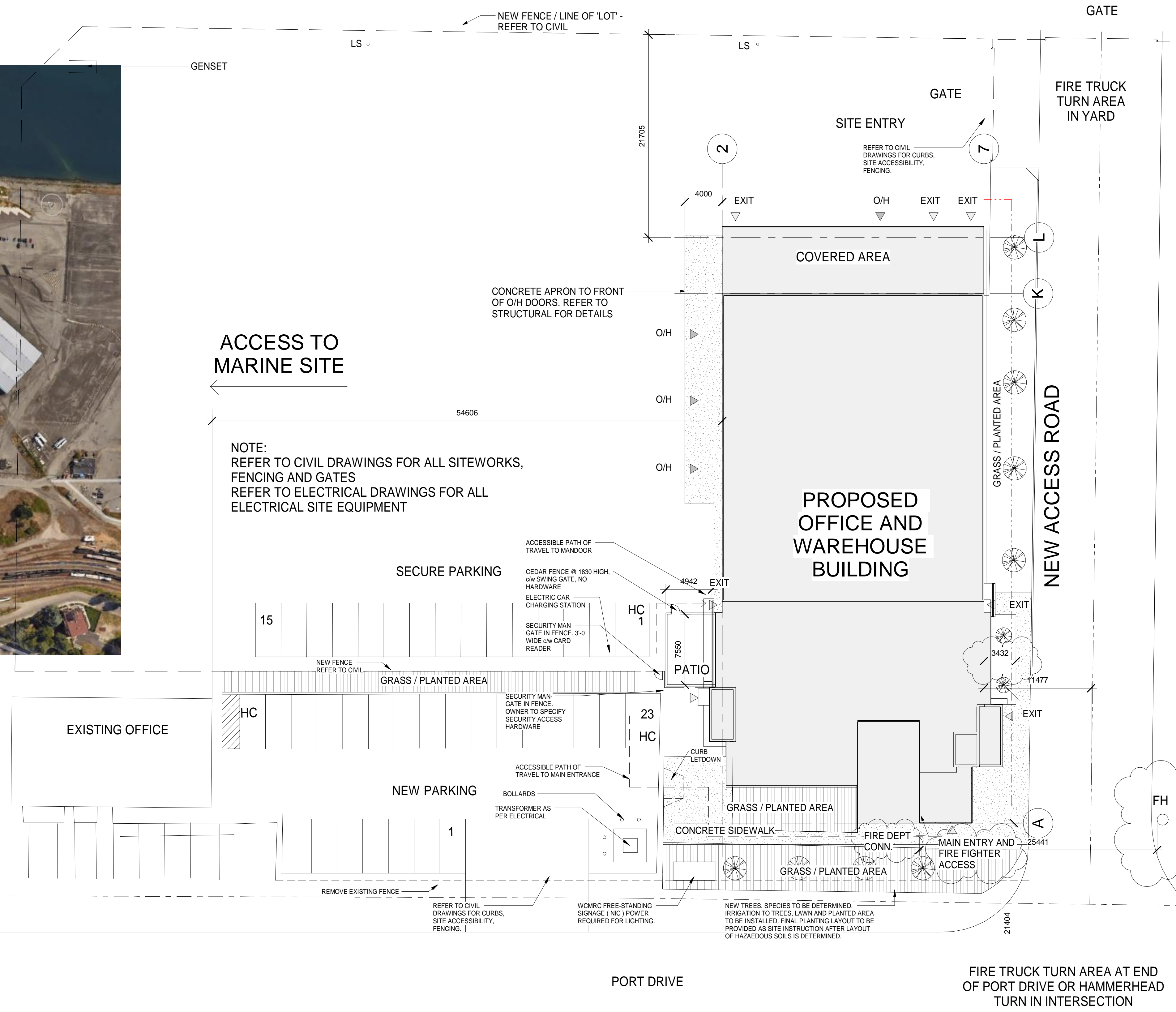

ACCESS TO MARINE SITE

NOTE: REFER TO CIVIL DRAWINGS FOR ALL SITEWORKS, FENCING AND GATES REFER TO ELECTRICAL DRAWINGS FOR ALL ELECTRICAL SITE EQUIPMENT

ISSUED FOR CONSTRUCTION

RECEIVED DP1197 2020-MAY-21 Current Planning

No.	DATE	ISSUED FOR
3	2017.04.21	75% REVIEW
5	2017.10.13	CLIENT REVIEW
7	2019.12.21	CLIENT REVIEW
8	2020.01.20	TENDER
14	2020.03.04	IFC
15	2020.03.23	CODE REVISIONS



WCMRC NPA RESPONSE FACILITY

NANAIMO ASSEMBLY WHAEVES, NANAIMO, BC
NANAIMO PORT AUTHORITY



2122 BRANDON RD. SHAWNIGAN LAKE BC
TEL: 250-891-1602



3701 Shenton Rd, Nanaimo, BC V9T 2H1
T: 250 751 8558 | F: 250 751 8559
E: mail@heroldengineering.com

Copyright reserved. This drawing remains the exclusive property and may not be reused or reproduced without written consent of Herold Engineering Limited.

SITE PLAN

DESIGNED KAR/BJK	SEAL
DESIGN REVIEW JK/BJK	
DRAFTED KAR	
DRAFTING REVIEW JK	
PROJECT No. 0386-063	CLIENT DRAWING No.
SCALE 1 : 250	PERMIT No.
HEL DRAWING No. A101	REVISION 15